

Quick-Check **Tension Meter**

The Dillon Quick-Check Tension Meter quickly measures tension in cable guardrails, guy lines and overhead wires. It installs, measures and removes in seconds. The digital loadcell is highly accurate and requires no lookup or correction tables.



Cable Tensioning

NEW

Store wire rope readings and export data
(Ideal for tower data collection)

- Time saving check-tensioning mode
- Portable and rugged – designed for outdoor use
- Built-in averaging saves time and eliminates errors
- Factory calibrated for up to 20 unique wire sizes and types

DILLON

Force Measurement Equipment



Sheaves with bearings eliminate friction and provide the best accuracy

Accommodates a wide range of wire sizes and styles

Telescoping handle engages meter quickly with minimal effort

Highly visible yellow finish

Easy-to-read backlit display with full-text prompts

RS-232 Port

Easy to use soft-key interface

Uses popular AA batteries and has long life between changes

The Fastest Cable Tension Meter

The Dillon Quick-Check can be placed on a cable, measure its tension, and removed in under five seconds! There are no complex lookup tables, no conversion charts. The operator can quickly select from 20 different wire sizes and types stored in Quick-Check's memory. The Check-Tensioning mode graphically displays the current and target tensions for extremely quick setting of line tension. Even the infrequent battery changes are quick.

Broad Application

The Quick-Check can be employed in many industries to ensure proper tensioning. Typical applications include tower and stack guy wires, pretensioned cable barriers, bridges, elevators, winch rope, overhead electric transit wires, fall arrest systems, aircraft cables and utilities.

Specifications

Tension capacities:

2000 lb/10 kN/1000 kg
10,000 lb/45 kN/4500 kg

Wire sizes: $\frac{3}{16}$ inch through 1 inch (4.75 mm through 25.4 mm)

View helpful ordering tips at dillon-force.com

Accuracy: $\pm 3\%$ instrument capacity (calibrated to specific wire size and type.)

Loading error: Cable elongation of only 0.08 inch (2mm)

Display: Dot-graphic LCD display supports full text and 1 inch high digits.

Sheave range: Each set accommodates rated wire size and $\frac{1}{2}$ " smaller. Multiple sheave sets may be used.

Suggested wire calibrations: Calibrate each wire diameter needed with the most appropriate sheaves. If two wire types are used of the same diameter (e.g. $\frac{1}{2}$ " 1x7 and $\frac{1}{2}$ " 6x19), calibrate each type independently if accuracy is critical.

Environment protection: Suitable for continued outdoor use.

Operating range: -4° F to 158° F (-20° C to 70° C)

Tension units of measure: pound-force, kilogram force, Newtons

Resolution: Configurable low/med/high

Product dimension: 9 x 24 x 3 inch (22 x 61 x 8 cm)

Product weight: Approx 11 lb (5 kg)

Shipping dimension: 28 x 16 x 8 inch (71 x 41 x 20 cm)

Shipping weight: 27 lb (12 kg)

Recalibration: At user discretion. Commonly 12 months; should be more frequent with heavy use. On-site recalibration may be possible through your Dillon distributor.

Approvals: CE

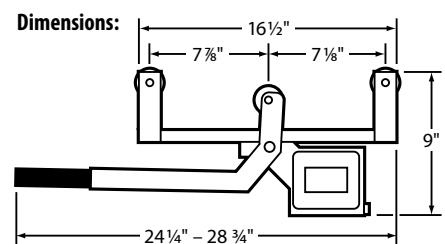

RS-232 port



Carry case included

Dillon also manufactures highly accurate electronic and mechanical dynamometers and crane scales.



DILLON

Dillon/Quality Plus, Inc.
214 E. Kansas St. Ste 101
Liberty, MO 64068

Toll Free: 800-493-2263
Email: sales@dqplus.com
Visit: www.dqplus.com